

General Description

The high current Press-Fit terminal blocks and spacers of the **PowerClamp** Series are designed for the solderless PCB or bus bar mount by the famous **SOFTPRESS** technique. This technology guarantees a very low contact resistance between the PCB and the **PowerClamp**. These **PowerClamp** components handle continuous currents from 100 up to 600 Amps and appear in different standard configurations:

- N** - Series – terminal block with internal thread (nut) - (see this document)
- B** - Series – terminal block with external thread (bolt)
- L** - Series – terminal block with 90° mounting (horizontal thread or hole)
- H** - Series – spacer without thread (through hole spacer)
- D** - Series – spacer with double press-fit zone

Various accessories allow the enlargement of the applications (see *accessories and applications*)



Technical Specifications

Metric thread	N1305M	N1306M
UNC thread	N1305U	N1306U
Current rating ¹⁾	200 A	
Metric thread size	t M5	M6
UNC thread size	t #12 - 24	1/4" - 20
Max. torque	4.1 Nm / 3.0 lbf ft	6.8 Nm / 5.0 lbf ft
Nom. insertion force (PCB) ²⁾	1'600 N / 360 lbf	
Min. extraction force (PCB)	1'100 N / 250 lbf	
Material	CuZn40Pb2 / CW617N	
Contact surface ³⁾	2 μ BroxAlloy	
Weight	12 g	16 g

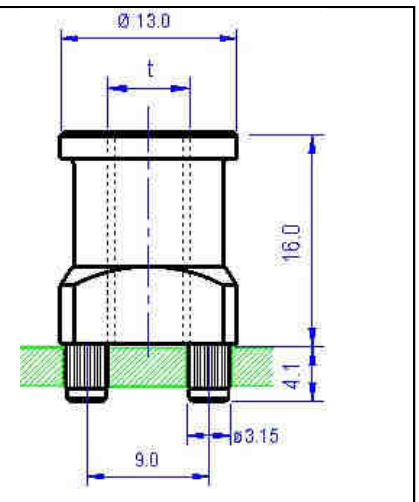

- 1) The max. current depends on the PCB copper thickness.
- 2) Depends on the PCB and the copper thickness.
- 3) On request other platings.

Recommended PCB Configuration

for PCB configuration see DT0101
http://www.broxing.com/Applications/dt0101_plated_holes.pdf

PCB thickness: 1.5 – 3.2 mm

PCB Press-Fit Standards:
IEC 60352-5, DIN EN 60352-5

PCB DRILLING PLAN

All specifications subject to change without notification. Consult >BROXING< for latest specifications